

		<b>杭州钱江压缩机集团有限公司</b> <b>HANGZHOU QIANJIANG COMPRESSOR</b> <b>GROUP Co.,LTD</b>		<b>技术参数表</b> <b>DATA SHEET</b>	
<b>型号</b> <b>Model</b>	<b>容积</b> <b>Displacement</b> <b>(cc)</b>	<b>额定电压/频率</b> <b>Rated voltage</b> <b>Frequency</b>	<b>制冷剂</b> <b>Refrigerant</b>	<b>冷却方式</b> <b>Cooling</b>	
<b>WS103H</b>	<b>10.3</b>	<b>220-240V~50/60Hz</b>	<b>R134a</b>	<b>Static</b>	
<b>基本信息 BASIC DATA</b>					
<b>电压范围 Voltage range(V):</b>		220-240V~50/60Hz			
<b>应用 Application</b>		LBP			
<b>蒸发温度范围 Evap.Temp Range. °C</b>		-35/-15			
<b>最高环境温度 Max Ambient Temp. °C</b>		43			
<b>节流方式 Expansion Device</b>		毛细管 CAPILLARY TUBE			
<b>电机类型 Motor Type</b>		RSIR			
<b>认证 Appoval</b>		CCC CE CB VDE			
<b>性能参数 PERFORMANCE PARAMATER</b>					
<b>测试工况 Test conditions</b>		<b>ASHRAE(LBP)</b>			
<b>测试电压 Test voltage</b>		<b>220V/50Hz</b>		<b>220V/60Hz</b>	
<b>制冷量 Cooling capacity (BTU/h)</b>		<b>955</b>		<b>1092</b>	
<b>(KCAL/h)</b>		<b>241</b>		<b>275</b>	
<b>(W)(≥95%)</b>		<b>280</b>		<b>320</b>	
<b>额定功率(≤115%) Rated Watts (W)</b>		<b>234</b>		<b>246</b>	
<b>额定电流(≤110%) Rated current (A)</b>		<b>1.87</b>		<b>1.75</b>	
<b>效率-EER(BTU/W)</b>		<b>4.08</b>		<b>4.44</b>	
<b>COP (W/W)(≥95%)</b>		<b>1.20</b>		<b>1.30</b>	
<b>附件 Accessories</b>					
<b>配件 Devices</b>			<b>数量 Qty.</b>		<b>类型 Type</b>
热保护器 Protector			1		WS103H
热保护器卡子 Protector buckle			/		
启动继电器 Starting Relay (PTC)			1		PTC 15Ω
电器罩壳 Cover			1		
罩壳卡子 Cover buckle			1		
运行电容 Running Capacitor			/		
接地螺钉组件 Earth screw assembly			1		
胶座 Rubber mat			4		
寸管 Sleeve			4		

	<p>杭州钱江压缩机集团有限公司 HANGZHOU QIANJIANG COMPRESSOR GROUP Co.,LTD</p>	<p>技术参数表 DATA SHEET</p>
---	--	-----------------------------

外貌图 **OUTLINE**

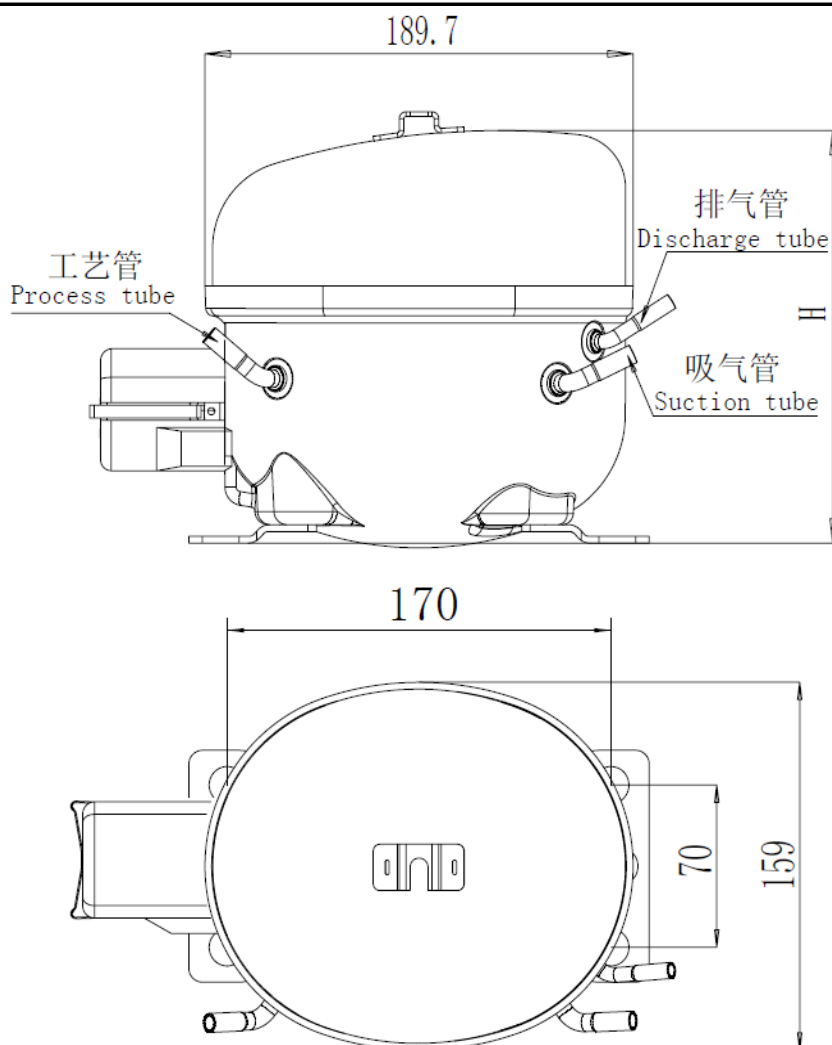

尺寸表 **Dimensions table**

高度 Height mm	181
吸气管 Suction tube inner diameter(S)	6.1±0.2
工艺管 Process tube inner diameter(P)	6.1±0.2
排气管 Discharge tube inner diameter(D)	4.9±0.2
每托盘数量 Compressors per pallet	
纸箱包装尺寸 Carton (one compressor)	
托盘尺寸 Pallet Dimensions	

接线图  
**Wiring Diagram**



说明书如有变动不另行通知。

Specifications subject to change without notice.

2017-11-2